

• Easy Cleaning

• High Efficiency

• For Commercial Use

品質 · 服務 · 創新
Quality · Service · Innovation

Dasin 達鑫機械有限公司
DASIN MACHINERY CO., LTD.

No.30, Ln.168, Sec.1, Dunhuang Rd., Caotun Township,
Nantou County 54257, Taiwan
TEL: +886-49-2318-335 FAX: +886-49-2314-063
E-mail: info@dasin-tw.com



Dasin



ST300 AUTOMATIC INSTANT
HEATING TEA BREWER
智能攪拌泡茶機使用手冊

www.dasin-tw.com

En 繁 簡

• 非專業人士請勿操作 •

■ 安裝指示說明

- 安裝機器須由專業人士執行並詳讀後遵守說明書指示，錯誤安裝可能對人員或機器造成損害，並影響機器的保固。
- 須單獨使用30A之漏電斷路器來供電給機器，並確定接上接地線以確保有情況時可做到保護（正確的接地是為了雷擊時確保機器可被保護，因為此類的天然災害也不在保固範圍內）。
- 須使用過濾器水，避免水雜質進入機器內部，可大大延長機器壽命及降低故障機率（如因水中雜質而造成的故障也不在保固範圍內）。
- 原廠進水管規格為2分1/4英吋RO管，進水速度每分鐘須超過500CC，如進水速度過慢機器會跳錯出錯誤警告，請改善進水店給水條件。（建議：加大給水管徑或裝加壓馬達都可幫助給水速度）。
- 機器須報修運送前或長時間不使用須收納時請排出機器內部的存水，避免過程中濕氣或水跑出讓電子零件受潮生鏽故障。（注意：排水時請記得先將進水關閉，避免水在進入水箱）。
- 首次使用機器時，機器會先進水到滿水位才會允許程式進行泡茶，這段時間約5分鐘。

請保存此說明書

■ 安全注意事項

- 開啟電源前，請確認水源供應正常（水箱如無偵測到高水位則無法正常泡茶）
- 使用本機時，務必將泡茶桶放置定位。並遵照程式進泡提示才可取下，泡茶過程中禁止觸摸茶桶，避免燙傷（如茶桶無確實定位機器不會啟動泡茶動作）
- 泡茶啟動前請記得將冷水壺或保溫桶放置在泡茶桶下方。
- 泡茶結束後將泡茶桶內的茶葉確實清潔乾淨，並檢查有無漏水。（如有漏水請拆下水機構做更確實的清潔）
- 每次泡茶後請將茶桶做好清潔並瀝乾，每日關店休息時請記得關閉電源。

⚠ 警示

- 請閱讀所有的指示。
- 請勿將茶葉以外之物品…放置於茶桶內，避免發生危險及造成機器損壞。
- 如果電線、插頭或其他附件受損時，請勿使用本產品。
- 如果電線損壞，必須交由達鑫公司或是專業人員更換，以免發生危險。
- 請在開啟本產品時，先確認所有零件無鬆動脫落等現象。
- 啟動泡茶模式，機器還沒完全下茶時，請勿抽出茶桶。
- 請勿使用其他製造商的任何配件和零件，或非達鑫建議之配件和零件，如果您使用非本公司的配件或零件，保固會立即失效。
- 本產品不適合供下列人士（包括小孩）使用：身體官能或心智能力退化者，或是經驗與使用知識缺乏者，他們需要有負責其安全的人員在旁監督，或指示產品的使用方法，方可使用。

■ 產品特色

- ※ 瞬熱設計-高效利用每一度電水箱不易結水垢
- ※ 預熱裝置-瞬熱搭配預熱四季泡茶口感更穩定
- ※ 攪拌裝置-浸泡中設定攪拌可使茶葉完全展開
- ※ 安全設計-智慧偵測泡茶茶桶移位及啟動斷電
- ※ 人機介面-簡易設定泡茶時間水量攪拌之參數

■ 產品介紹

1.產品規格 ST300(標準版) / ST300S(加高版)

功 率	4200W	進 水 方 式	自動進水
電 壓	220V/50~60HZ	適 用 範 圍	茶葉
淨 重	20KG/21KG(ST300S)	泡 茶 桶 材 質	SUS 304
毛 重	25KG/26KG(ST300S)		
產 品 尺 寸	55.4x26x73.2cm (L.W.H) 55.4x26x82.2cm (L.W.H) (ST300S)		

2.產品部位說明

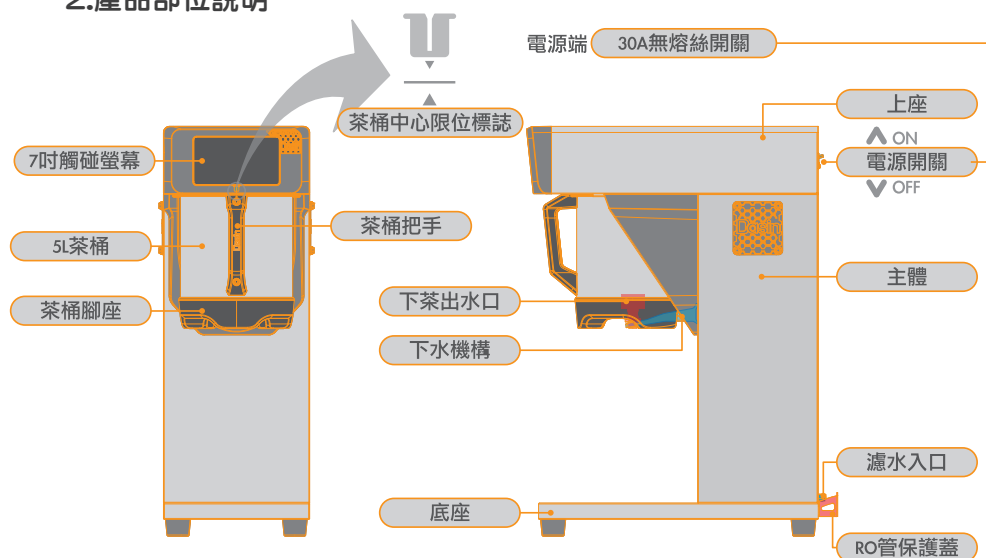

■ 產品使用說明

一、介面介紹



- 按日期顯示處 可進入使用計次查詢使用狀況。
- 共20組模組設定，由01~10編號按 可切換為11~20編號， 回前頁。
- 參數設定—可設定時間日期/密碼變更/使用計次/進階設定/水箱排水/回復原廠/中英語言切換/維修測設。
進入 參數設定需輸入預設密碼8888進入
如已更改密碼，請輸入新密碼。
- 泡茶設定—可設定多達20組模組(茶類/注水量/浸泡/溫度/攪拌/靜置)。
進入 泡茶設定需輸入預設密碼0000進入
如已更改密碼，請輸入新密碼。
- 技術手冊： 安裝說明 維修測試 產品規格 拆卸及清洗 故障圖示

二、泡茶參數設定





- ① 按 選擇01~20組泡茶參數，設定框左邊會顯示選定的組別。
- ② 選定茶類，選擇後設定框左邊會顯示選定的茶種。**(不顯示茶類為選擇-空白)**
- ③ 設定注水溫度(85°C~97°C)/設定浸泡時間(1s~3000s)，設定總注水量(100cc~5000cc)。
- ④ 設定兩階段靜置和攪拌。(如不設定，請輸入0秒作為參數)
設定值大於總浸泡時間時會彈出 提示。
- ⑤ 設定完成後按存檔，顯示 **儲存完成** (預設定多組類別，重複1~5步驟)。
- ⑥ 完成後按 鍵回主頁面。

二、泡茶參數設定



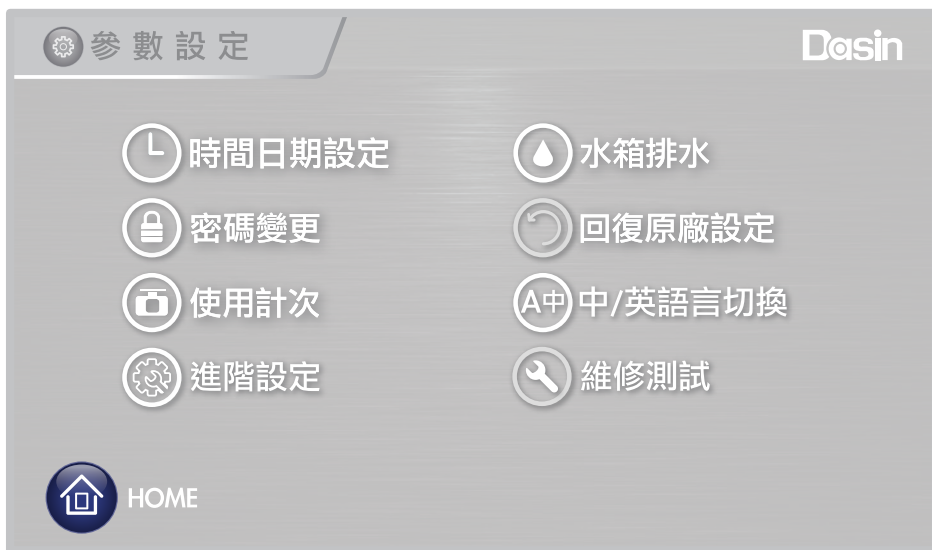



- ① 按 鍵啟動泡茶，HOME鍵呈灰色 (無法返回) 按下 停止泡茶 **停止泡茶** ，才能回到主頁面(此時HOME鍵呈藍色)。
- ② 啟動泡茶時，如顯示 預熱動作，完成後才會進行泡茶運作。
- ③ 泡茶參數顯示區域。
- ④ 待機→茶桶置入→注水→攪拌→靜置→下茶→泡茶完成 顯示動畫。

三、參數設定 

 **時間日期設定**：輸入年/月/日設定和時/分/秒



 **密碼變更**：選擇要修改→參數設定，或是→泡茶設定
如無更改過，參數設定預設碼為8888，泡茶設定預設碼為0000
建議修改密碼來增加安全性；輸入最多為12個數字碼。
輸入完成後按  鍵，此時會彈出 **儲存完成**
儲存完成後按  鍵回主頁或  參數設定 回參數設定頁。

三、參數設定  使用計次

- 1 當日計次：顯示每日的使用次數
- 2 月顯示：顯示每月的使用次數
- 3 使用紀錄查詢：點選左右鍵來選擇年分，進而查詢使用次數

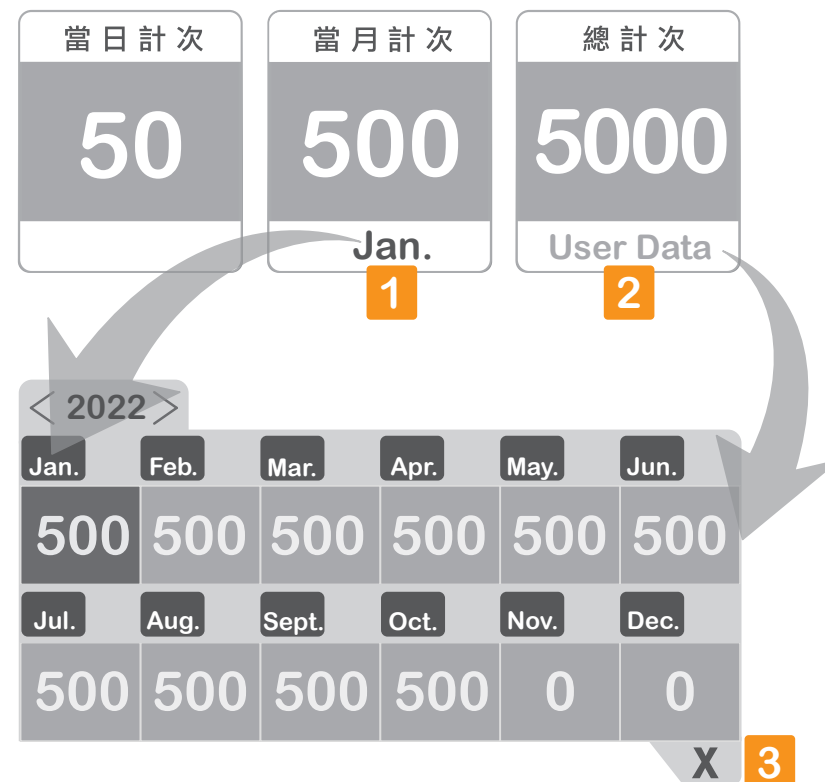

三、參數設定

進階設定 (請洽專業人員設定)

1 數據監控	ON/OFF	2 泡茶完成提示聲	ON/OFF
3 下水時間設置	<=2500cc 60	<=2500cc 65	<=4500cc 75
4 下水模式設置	一般	進階	
5 流量脈波設置	105	1K	2K 3K 4K 5K
6 節能設定	15 min	30 min	
7 預熱方式	自動	非自動	
8 泡茶最低溫度	85		

設定時間內無泡茶,將不自動預熱

開機即自動預熱 泡茶前預熱

設定範圍85~97度

1. 數據監控

電磁鐵	60	K1水箱	55
預熱	50	K2出水	97

電磁鐵：下茶總時間

K1水箱：水箱溫度

預熱：預熱溫度

K2出水：出水溫度

- 泡茶完成後響三聲來提示。
 - 可依不同下水容量進行設定。
 - 一般(無)/進階(敲三下)為出廠預設值。
 - 可獨立增加各區間的水量值CC(預設值為不增加)。
 - 可設定泡茶結束的15或30分鐘後進入節能省電模式。
 - 可設定：開機即自動預熱或泡茶前預熱。
 - 出廠預設值85°C。
- (設定85°C時，水箱預熱會調低，泡高溫茶時須等待多一點時間)

三、參數設定

水箱排水

排水前,確認已將水源開關關閉

START/STOP

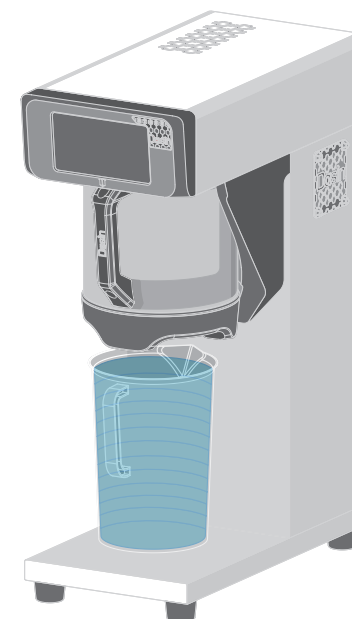

何時使用排水功能？

- 一星期內皆無使用機器。
- 維修或搬運機器時。

按啟動後按鈕呈 **START/STOP**，此時顯示動畫為-茶桶置入提醒-感應到茶桶後進行水箱排水動作。

回復原廠設定

回復為出廠設定值。

中/英語言切換

中文/English，內建中文及英語二種語言切換。

三、參數設定

🔧 維修測試

1 排水測試 ON/OFF

排水前，確認已將水源開關關閉。

2 馬達測試 ON/OFF

3 PUMP 測試 ON/OFF

4 電磁鐵測試 ON/OFF

5 流量脈波設置

	1K	2K	3K	4K	5K
	1K<=1000	1000<2K<=2000	2000<3K<=3000	3000<4K<=4000	4000<5K<=5000

1. 水箱排水測試。
2. 測試-馬達-有無異常。
3. 測試-PUMP-有無異常。
4. 測試-電磁鐵-有無異常。
5. 可獨立增加各區間的水量值CC(預設值為不增加)(同排水功能)。

四、茶桶拆卸與清洗

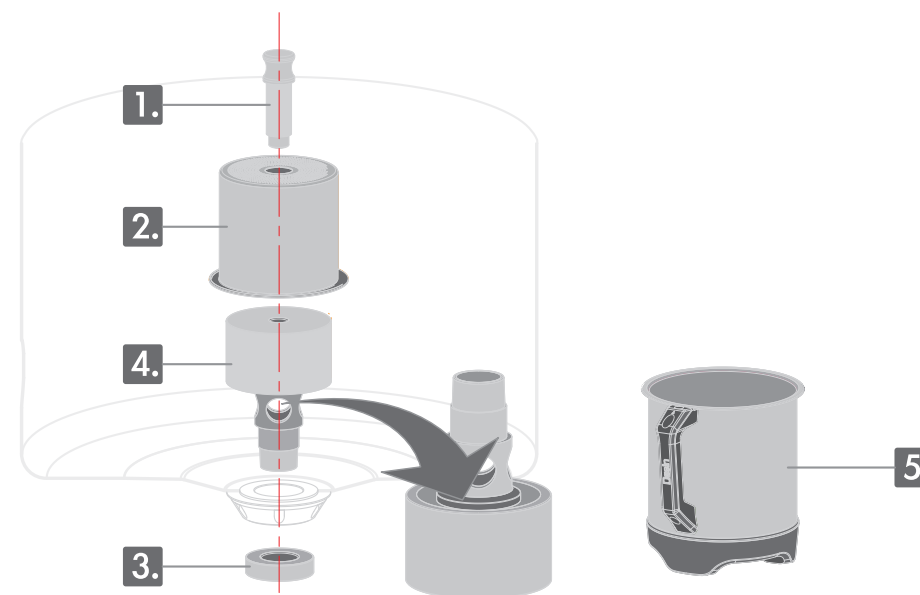

1. 轉開濾網旋鈕
2. 將濾網取出
3. 將下水環旋鈕轉開取下
4. 確認防水墊有無異物和清洗
5. 清洗茶桶和茶垢
6. 將茶桶零件組回(步驟4~3~2~1) 組完後確認有無漏水

五、故障碼圖示

溫度異常故障碼



水箱溫度異常

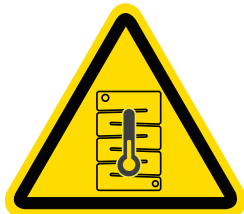

泡茶溫度異常

水量異常故障碼



水箱水量異常



出水流量異常

系統異常故障碼



輸入錯誤數據



通訊異常

五、狀態顯示說明

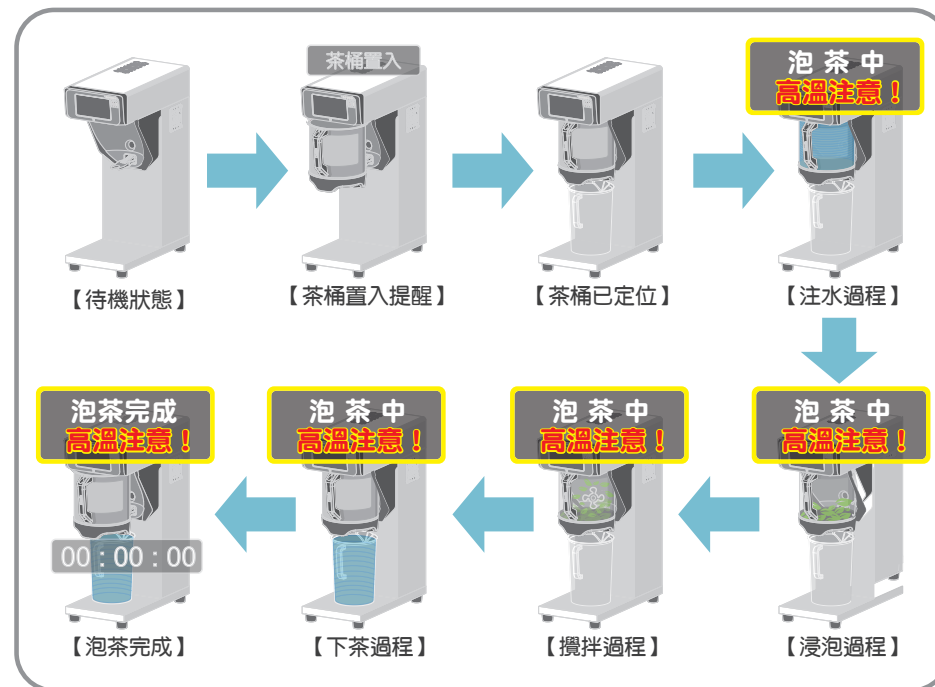

六、異常排除

【偵測到故障時之處理方式】

a. 偵測到故障碼時：

按下→偵測故障、參數重啟按鈕，來進行偵測；偵測無問題後可繼續泡茶。

b. 偵測到故障碼時：

按下→偵測故障、參數重啟按鈕，來進行偵測；如再出現故障碼即為零件損壞，請送回原廠維修。



六、異常排除

【茶桶漏水處置方式】

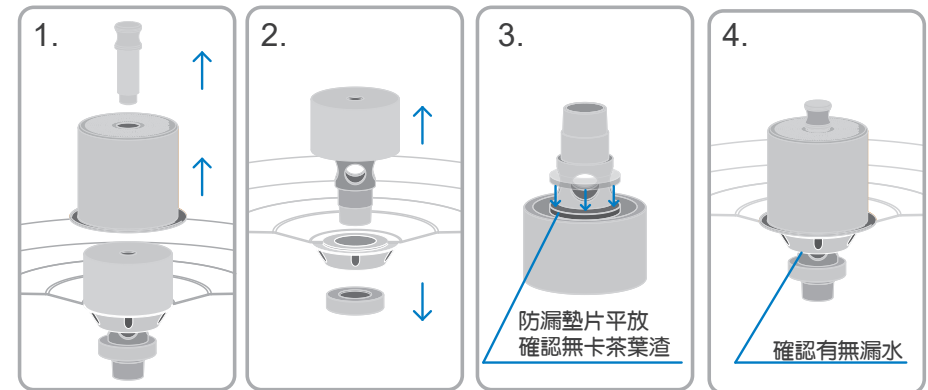

1. 取出濾網固定鈕和濾網。
2. 旋開螺母，取出下水塊。
3. 檢查防漏墊片是否平放或有卡茶葉渣。
4. 裝回下水塊，鎖回螺母，檢查有無漏水？

七、水源安裝方式

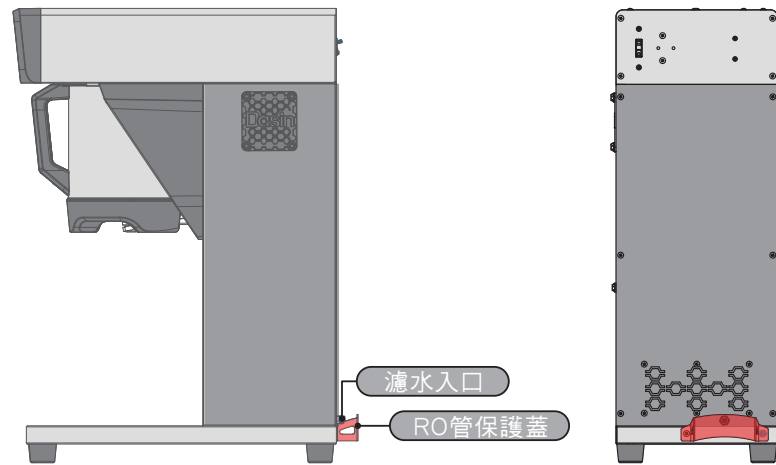

建議使用軟水器或可抑制石灰質過濾器搭配使用！

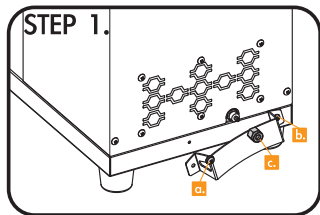

- 1.先確定水源方向(例:如水源方向為圖示左方)
- 2.先將左側擋片上螺絲和墊片卸下(a.)
- 3.將右側螺絲轉鬆(b.)
- 4.將螺帽卸下(c.)

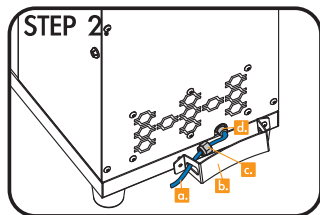

- 1.將1/4“ RO管(a.)先穿過擋片側孔(b.)，接著穿入螺帽(c.)
- 2.再將1/4” RO管塞入快速接頭上

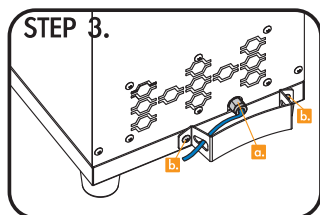

- 1.將螺帽鎖固(a.)
- 2.再將擋片螺絲鎖回(b.)

八、電源線安裝方式

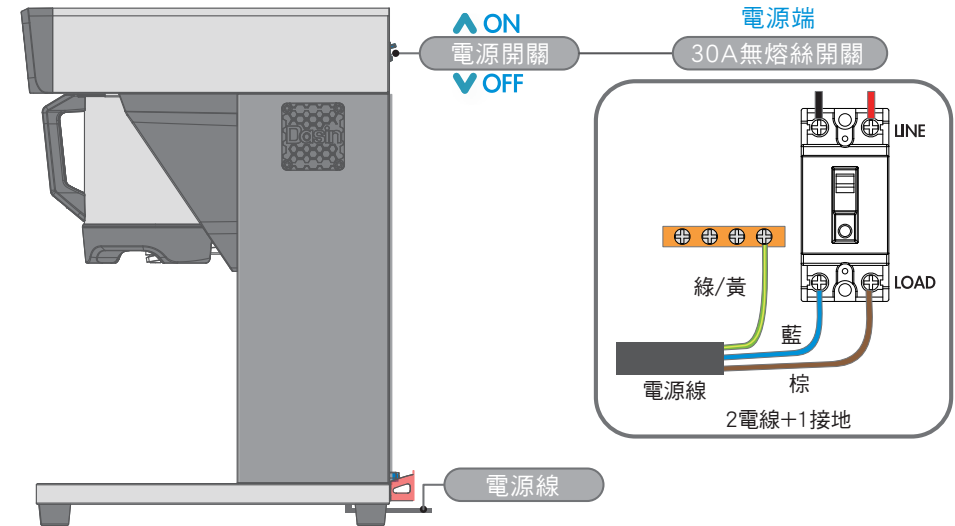

九、裝機前-電源端—電流檢驗方式

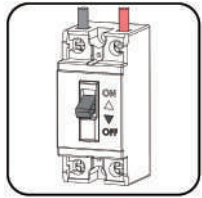

1. 總電源端請切到關閉位置
(顯示應為OFF側)。

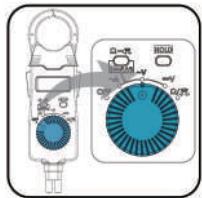

1. 使用三用電表，選擇交流電測量值區域
(為顯示~V的位置)。

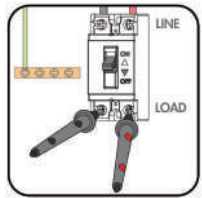

1. 使用電表探棒分別接觸在兩側負載端做
重複確認有無過電。



1. 在無通電狀況下，三用電表上僅顯示極
低的微電流值(約在3V以內)。

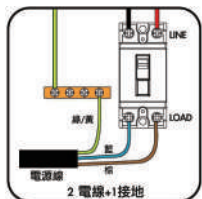

1. 確認是否無過電。
2. 將機器電源線正確的裝上(綠為接地)。
3. 電源端開啟為(OFF側)後便可通電使用設備。

■ INSTALLATION INSTRUCTIONS :

1. Make sure that this appliance is installed according to the INSTALLATION INSTRUCTIONS by qualified personnel before attempting to use it. Failure to follow the INSTALLATION INSTRUCTIONS could result in personal injury or void the warranty.
2. 30A residual current circuit breaker must be used, make sure the machine is properly grounded in order to ensure safety. (Correct grounding can protect the machine from lightning strikes, which is also not under warranty)
3. A water filtration system is required to prevent the scale formation which will shorten the service life of the machine.
4. Original inlet pipe is 1/4" RO pipe, inlet velocity should be over 500 CC, ERROR alert when inlet velocity is low. (Advice: use the pipe with a larger diameter or install a water pump)
5. Drain out the water from the machine before shipping to repair or without using for a long time to avoid rust and damage of electronic components. (Note: turn off inlet water before drainage)
6. It will take 5 minutes for the machine to get to the full water level the first time you use the machine before it can brew the tea.

Please Save The User Manual

■ CAUTION :

1. Make sure the supply of water is normal before turning on the power. (Machine will not work if water level is low).
2. Make sure the tea bucket is in position and keep hands, arms and other items away from hot surface of the tea bucket during operation, do not take out the tea bucket during operation. (Machine will not start if the tea bucket is not in position)
3. Put an extra container under the tea bucket before starting the machine.
4. Wash the tea bucket after using the machine and check if there is leakage. (Disassemble the tea bucket for further cleaning if there is leakage)
5. Clean and drain the tea bucket regularly after using, turn off the powder when the machine is not used for a long time.

⚠ DANGER

- Read All Instructions.
- Never put other things except for tea leaves(tea bags, tea powder...) into the tea bucket to avoid danger and damage to the machine.
- Do not use the product if the plug, the mains cord or other parts are damaged.
- If the mains cord is damaged, you must have it replaced by Dasin or professionals in order to avoid danger.
- Make sure all the parts are tight and secure before running the machine.
- Keep body parts clear of the brewer during brewing, do not remove the tea bucket while "tea brewing" appears on the display.
- Your warranty will be invalid immediately by using attachments not recommended or sold by Dasin.
- The product is not suitable to be used by the following people (including children) : those who are physical or mental faculties degenerated and those who are lack of using experience and knowledge. They should be supervised by staffs that are responsible for safety and indicating using method.

■ IMPORTANT NOTES

- ※ Instant heating – efficient utilization of electricity and less limescale
- ※ Preheating System – higher stability and efficiency
- ※ Stirring Apparatus – unfold tea leaves completely for releasing more fragrance of tea
- ※ Safety Design – intelligent detection of position for tea bucket
- ※ Human Computer Interface – convenient setting for making tea with customized water volume, temperature and stirring time

■ PRODUCT INTRODUCTION

1.SPECIFICATIONS : ST300(STANDARD) / ST300S(PLUS)

Power	4200W	Water Filling	Automatic
Volts	220V/50~60HZ	Apply To	Tea Leaf
Net Weight	20KG/21KG (ST300S)	Bucket Material	304
Gross Weight	25KG/26KG (ST300S)		
Package Dimensions	55.4x26x73.2cm (L.W.H)		
	55.4x26x82.2cm (L.W.H) (ST300S)		

2.PARTS DESCRIPTIONS

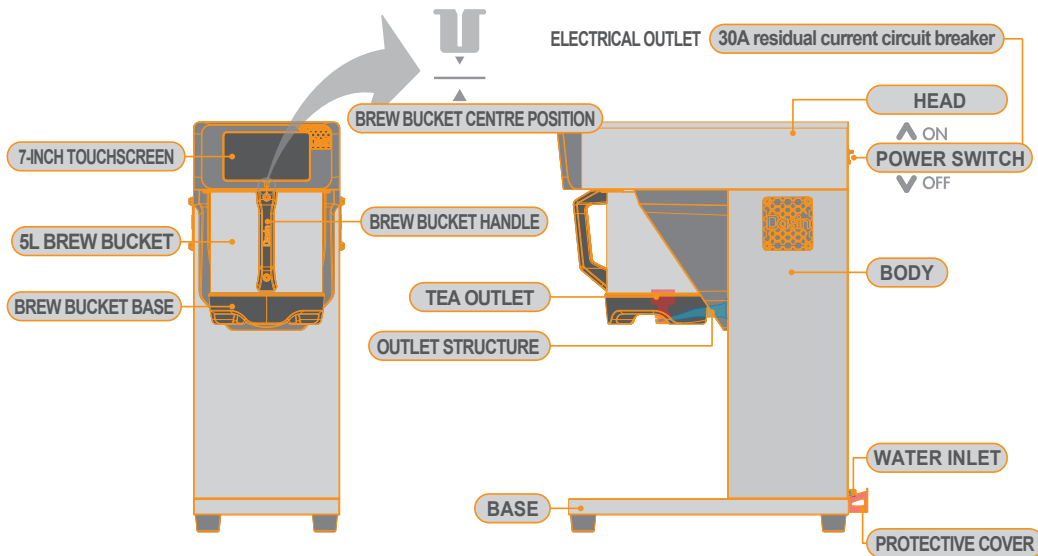

■ OPERATION INSTRUCTION

1 · PROGRAMMING GUIDE



- ① Press the DATE to check the frequency of use.
- ② Select 01~20 for different tea brewing recipe, press to show 11~20, press to return to the previous page.
- ③ Parameter settings: Date & Time/Change passcode/Frequency of Use /Advanced Settings/Tank Drain/Reset All Settings/中文/English/ Maintenance Testing.
The default password for parameter settings is 8888,
please enter new password after changing the default password.
- ④ 20 groups of tea brewing recipe (tea type/water volume/immersion time /temperature/stir/standing time).
The default password for tea brewing settings is 0000,
please enter new password after changing the default password.
- ⑤ USER GUIDE:
 - INSTALLATION INSTRUCTIONS
 - SPECIFICATIONS
 - ERROR CODES
 - MAINTENANCE TESTING
 - CLEANING INSTRUCTIONS
 - ERROR

2 · BREWING SETTINGS

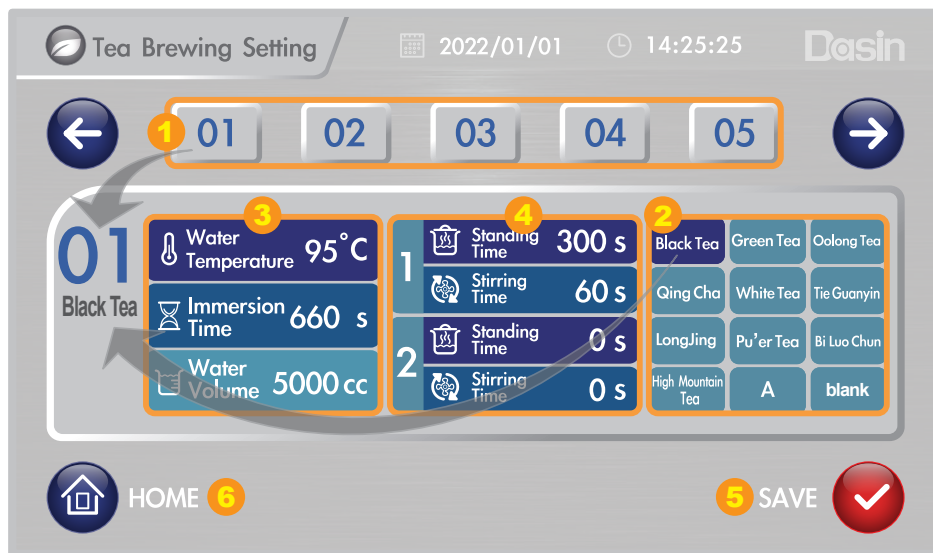

- ① Press to select 01-20 for 20 groups of tea brewing recipe, the selected group number will be displayed the left of the setting box.
- ② The selected type of tea will be displayed on the left of the setting box. (Type of tea will not be shown when select BLANK)
- ③ Water temperature setting(85°C~97°C)/ Immersion time setting (1s~3000s)/ Water volume setting(100cc~5000cc)
- ④ Settings for two sections of standing time and stirring time (input 0 second as parameter when there is no need of standing and stirring), will popup when the set value is higher than immersion time.
- ⑤ will be displayed on the screen when press SAVE to complete settings. (For more settings of other types of tea, repeat step one to five.)
- ⑥ Press to go back to the home page.

2 · BREWING SETTINGS



- ① Press to start turns grey (unable to return to home page), press to stop , and return to the home page (turns blue).
- ② If is displayed on the screen after pressing start, the brewer will start to brew after preheating.
- ③ Tea Brewing Parameter
- ④ Standby–tea bucket in position–water filling–stirring–standing–tea out–complete. Animation Display

3 · PARAMETER SETTING

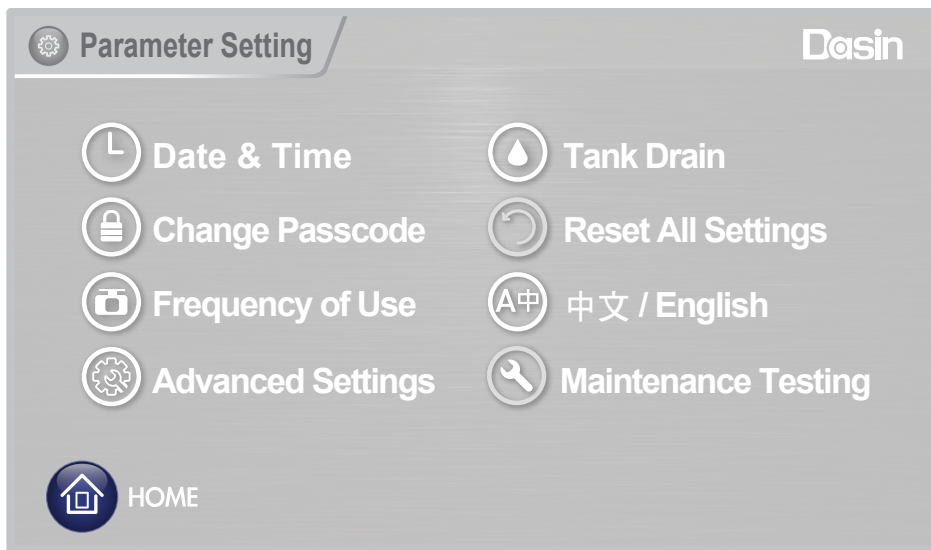

 **Date & Time** : YEAR/MONTH/DAY HOUR/MINUTE/SECOND



Change Passcode

Select **Parameter Setting** parameter setting or **Tea Brewing Setting** brewing setting.

Factory default for parameter setting: 8888

Factory default for brewing setting: 0000

Enter maximum 12 digital code to change password for improving security.

Parameter Setting	8888	Old passcode
	Input 12 digital codes at most	
Tea Brewing Setting	123456789	New passcode
	Input 12 digital codes at most	
	123456789	New passcode
	#Enter your new Passcode again#	

3 · PARAMETER SETTING

Frequency of Use

- 1 **Day** : frequency of use on the day
- 2 **Month** : frequency of use on the month
- 3 **Record search** : select year and month to search the record

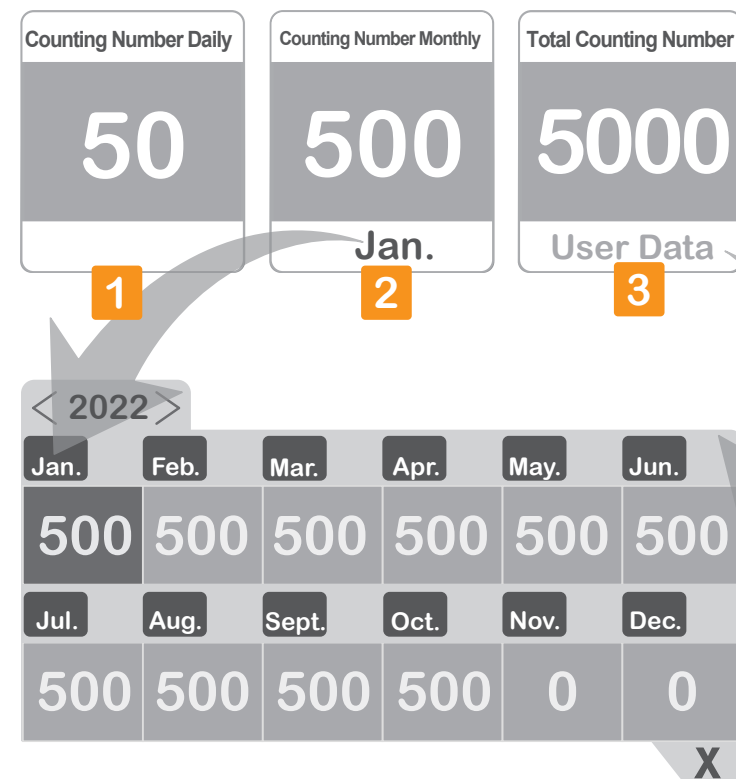

3 · PARAMETER SETTING

Advanced Settings (for professionals)

1 Data Monitoring **ON/OFF** 2 Alert for completion of tea brewing **ON/OFF**

3 Outflow Time Setup <2500cc **60** <=2500cc **65** <=4500cc **75**

4 Outflow Mode Setup General **Red** Advanced **Green**

5 Supplementary Water Volume **105** 1K 2K 3K 4K 5K
 1K<=1000 1000<2K<=2000 2000<3K<=3000 3000<4K<=4000 4000<5K<=5000

6 Energy Saving Settings 15 min **Green** 30 min **Red**
 If no action during a set time, the brewer will stop automatic preheating.

7 Preheating Automatic **Green** Non-automatic **Red**
 Start with automatic preheating Preheating before tea brewing

8 Tea brewing **85**
 Temp range:85~97 degree

1.enable data monitor

Outflow time	60	K-type1	55
Preheating	50	K-type2	97

electromagnet: outflow time
 K1 water tank: water tank temperature
 preheating: water tank preheating temperature
 K2-water outlet: water outlet temperature

2. reminder alert for completion.
3. set according to different water volume.
4. water outlet: general (click one time)/advanced (click three times): factory default.
5. increase water volume separately for each range (no increase for factory default).
6. get into powder saving mode 15 minutes or 30 minutes after completion.
7. Default lowest brewing temperature is 85 degrees.
 (When lowest temperature setting to 85 degrees, water tank preheating temperature will be lower, and it will cost more time to brew high temperature teas).

3 · PARAMETER SETTING

Tank Drain

Make sure to shut off the water supply before draining the water.

 START/STOP

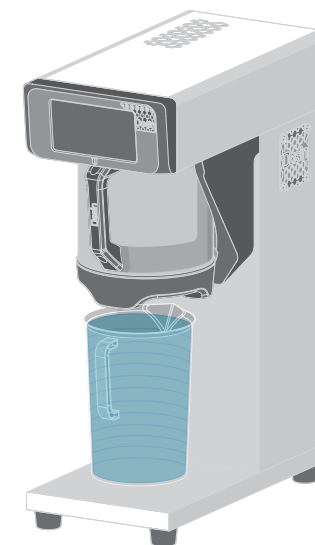

When to drain the tank?

- a. when the machine has not been used for one week
- b. when the machine is needed to be repaired or transported.

Press START and it will turn to  ,
 “tea bucket in place” will be shown on the screen, then the machine will automatically drain the water from the tank.

Reset All Settings

Press RESET to factory default.

中文 / English

Language : Chinese/English.

3 · PARAMETER SETTING

Maintenance Testing

1	TANK DRAIN	ON/OFF
Make sure to shut off the water supply before draining the water.		
2	MOTOR TESTING	ON/OFF
3	PUMP TESTING	ON/OFF
4	OUTFLOW TESTING	ON/OFF
5	Supplementary Water Volume	<input type="checkbox"/> 1K <input type="checkbox"/> 2K <input type="checkbox"/> 3K <input type="checkbox"/> 4K <input type="checkbox"/> 5K <small>1K<=1000 1000<2K<=2000 2000<3K<=3000 3000<4K<=4000 4000<5K<=5000</small>

1. Make sure to close the water inlet valve before drainage.
2. Check stirring motor for any abnormality.
3. Check PUMP for any abnormality.
4. Check electromagnet for any abnormality.
5. Increase water volume separately for each range (no increase for factory default).

4 · DISASSEMBLING & CLEANING

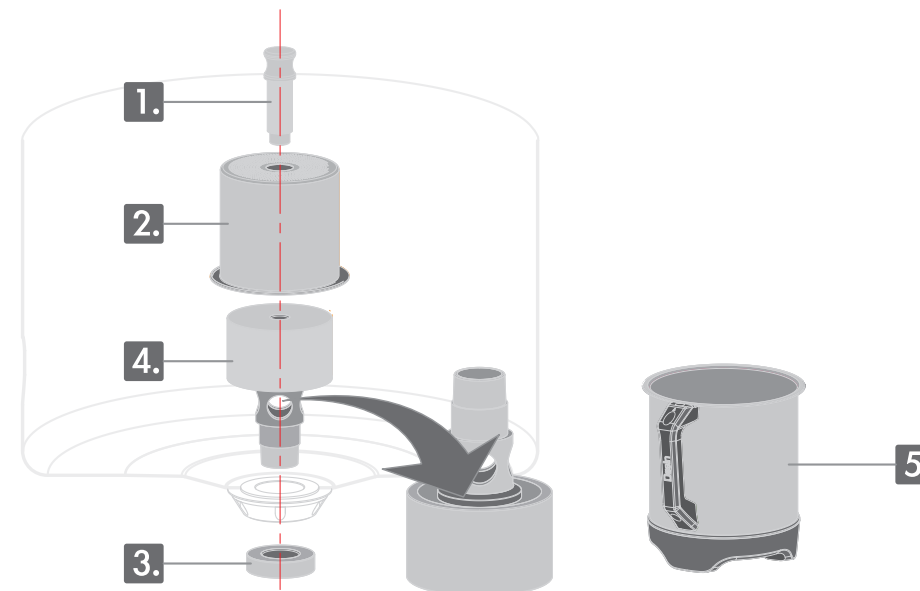

1. Unscrew the knob of the sieve.
2. Remove the sieve.
3. Unscrew and remove the water outlet knob.
4. Clean debris and residues on the waterproof gasket.
5. Clean debris and residues in the brew bucket.
6. Reassemble the brew bucket (step 4~3~2~1) and make sure there is no more leakage.

5 · ERROR CODES

Temp. Error



abnormal water temperature

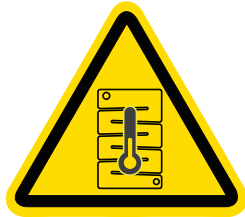

abnormal water temperature after heating

Water Level Error



abnormal water volume



abnormal water yield

System Error



enter wrong data



no connection

5 · STATUS

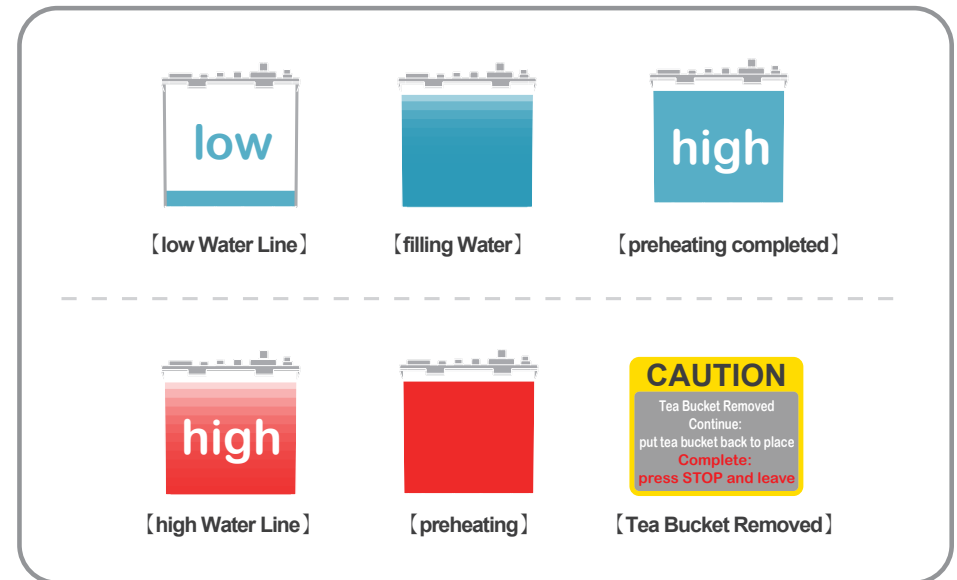
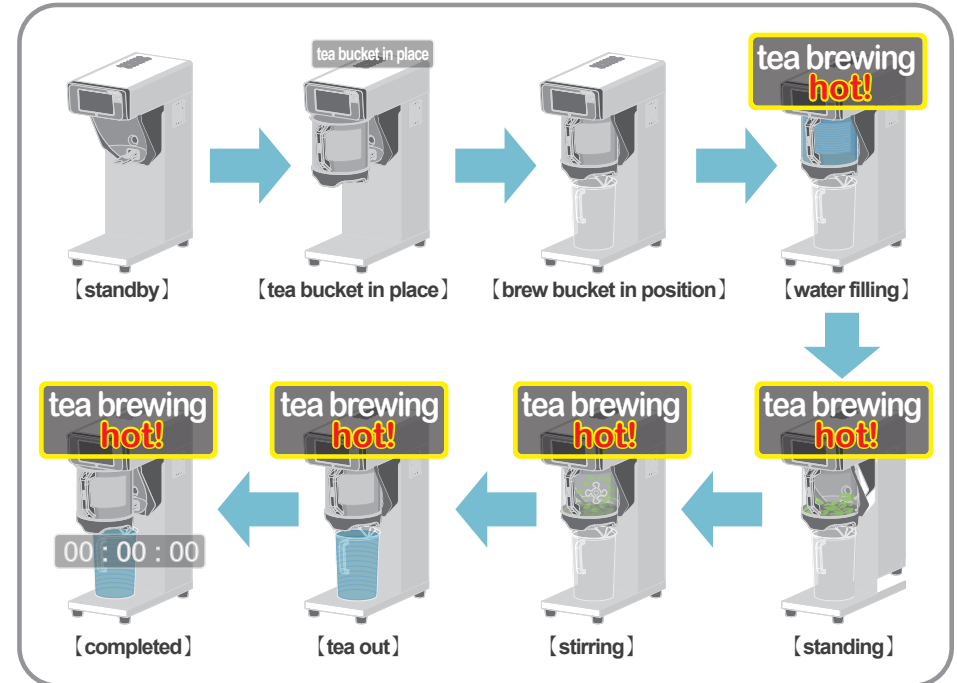

6 · TROUBLESHOOTING

【A. Remedy for detected fault】

- When a fault is detected, press “fault detected and restart parameter” to start detection, continue to use the machine if there are no problems detected.
- When a fault is detected, press “fault detected and restart parameter” to start detection, if the error codes jump out again, please return the machine back to the factory repair.

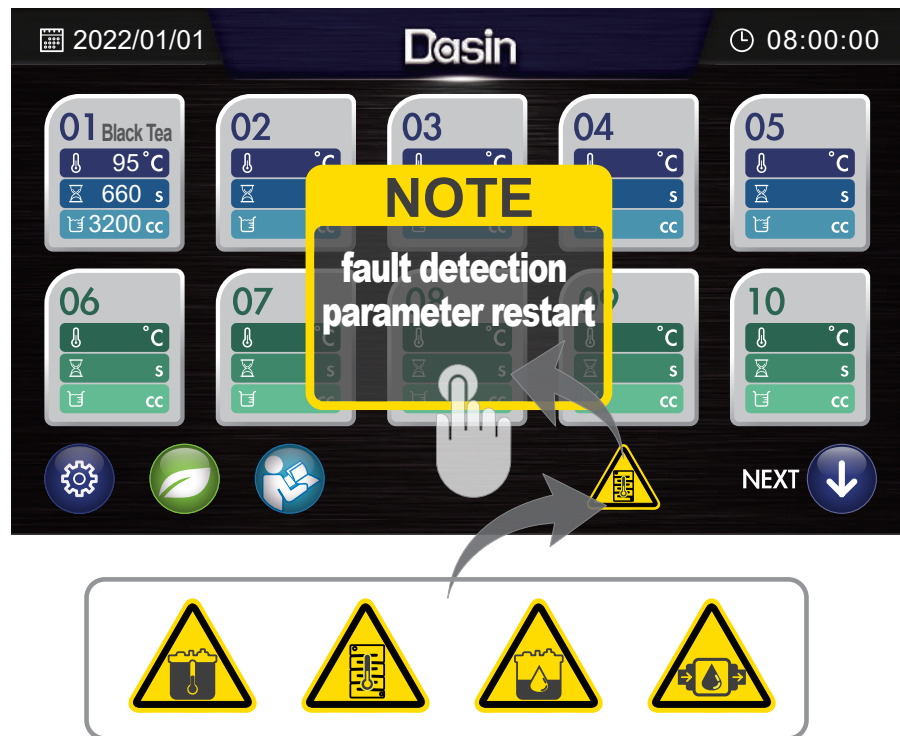

6 · TROUBLESHOOTING

【Remedy for tea bucket leakage】

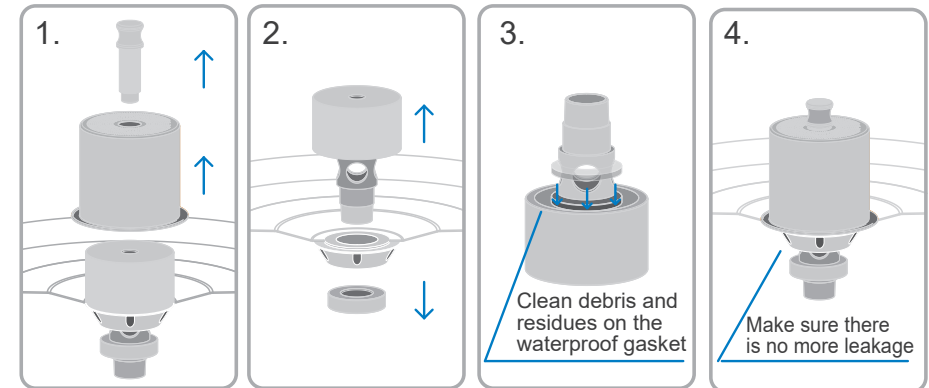

- Unscrew the knob of the sieve and remove the sieve.
- Unscrew and remove the water outlet knob.
- Clean debris and residues on the waterproof gasket.
- Reassemble the water outlet knob and make sure there is no more leakage.

■ PLUMBING HOOK-UP

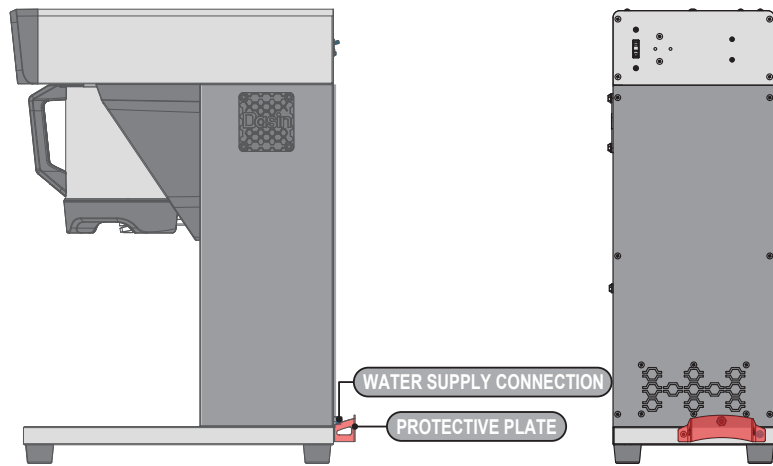

Water softener or water filtration system is suggested to use along with the brewer.

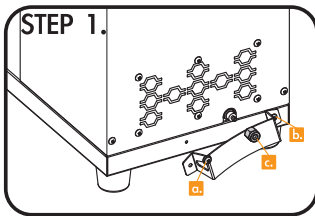

- STEP 1.**
1. Confirm the water supply position first. (water supply is on the left side as is shown of the picture)
 2. Remove the screw and washer on the left side of the protective plate (a.).
 3. Release the screw on the right side of the protective plate (b.).
 4. Remove the nut (c.).

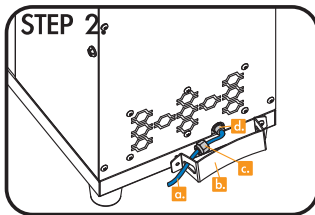

- STEP 2.**
1. Put 1/4" RO tube (a.) through the protective plate(b.) and the nut(c.).
 2. Insert 1/4" RO tube (a.) through the protective plate(b.) and the nut(c.).

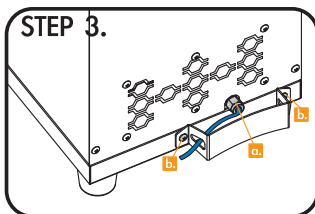

- STEP 3.**
1. Tighten the nut.
 2. Tighten the screws on the protective plate.

■ ELECTRICAL HOOK-UP

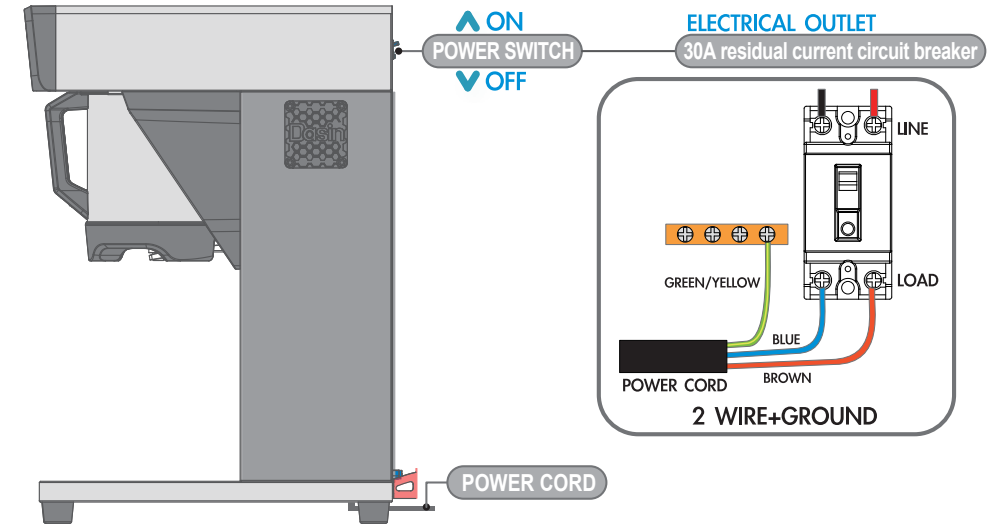

9、CURRENT DETECTION BEFORE USING

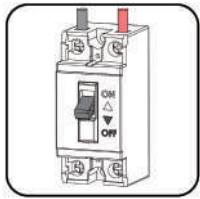

1.turn off the power supply.

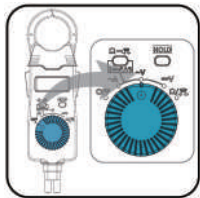

1.use a multimeter, choose AC(alternating current).

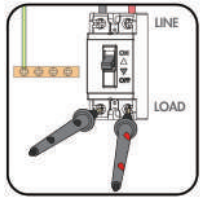

1.connect the test bar to the power to check if there is electricity.



1.multimeter only shows small current(<3V) when the power is off.

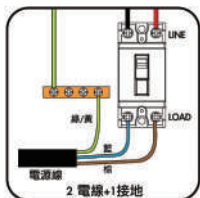

1.make sure the ground connection is correct (ground lead is green)
2.turn on the power.